

Building D1
1417 SE Rasmussen Blvd

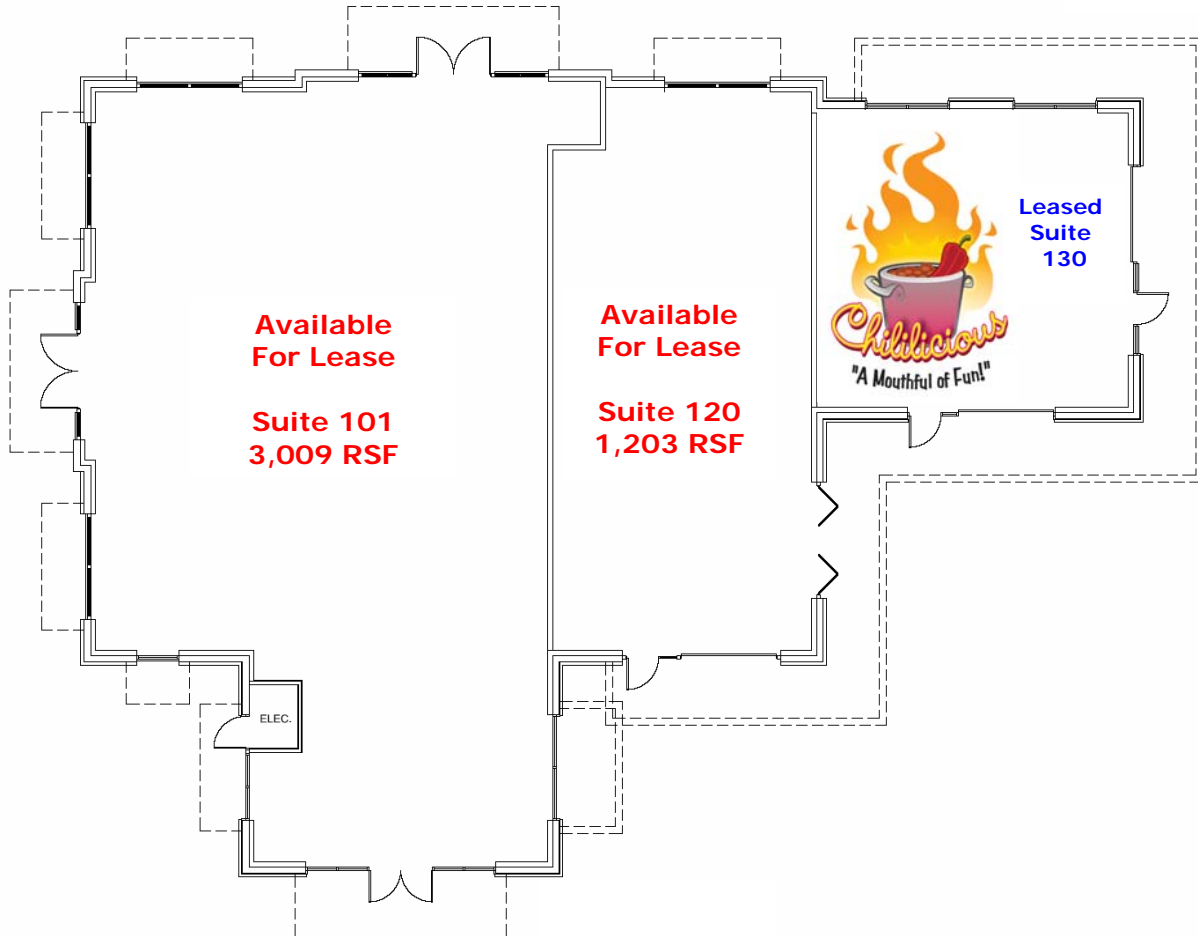

1417 SE Rasmussen Blvd has superior corner visibility from both SE Commerce Ave. and SE Rasmussen Boulevard. SE Commerce Avenue runs south-north from 199th Street (a main east-west arterial). The building features two entrances for each space, with the secondary entrance bordering the esplanade that runs through the center of BG Village. This building can be divided into three individual suites of varying size or occupied as one suite.

Building D1 is RSF 5,242

For Leasing Information: